

# Office to let

## HBC Dorobanti

Bucharest, Sector 1, Street Emil Pangratii, No. 30A

### Building information

Building status	Existing
Year of construction	2014
Parking ratio	1 / 107 sq m
Total building area	2 900 sq m

### Commercial terms

Office space*	after login *
Parking	after login *
Service charge*	after login *
Minimum lease term	after login *
Availability	after login *

\* Asking terms for m<sup>2</sup>/month

### Location

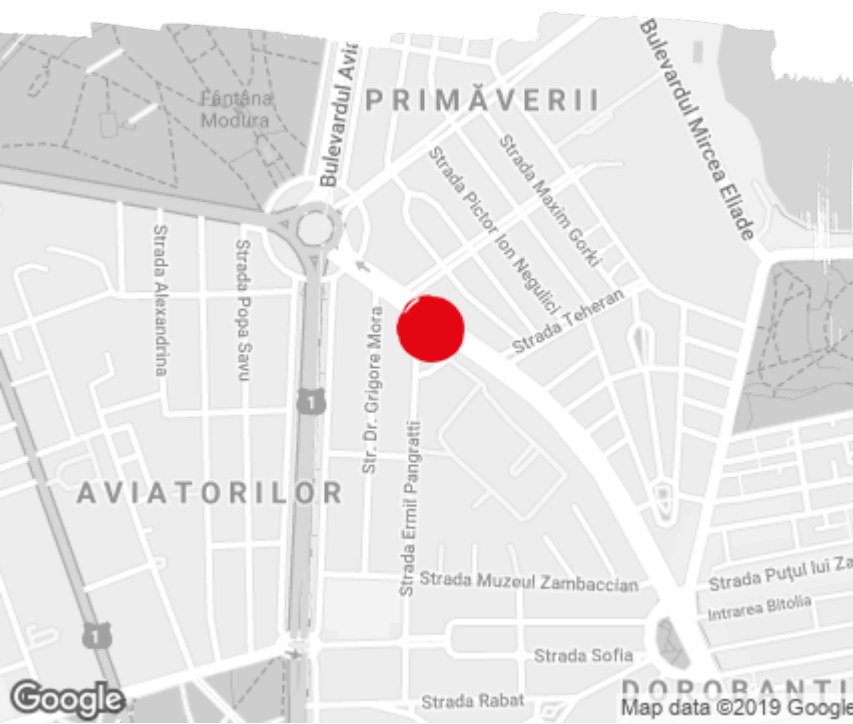

### Available space

Building completely leased

## Typical floor plan

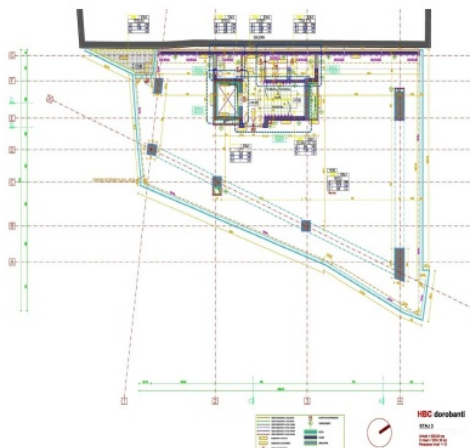

## Public transport

Metro: M2

Bus: 131, 282, 301, 330, 331, 335

## Contact



+40 21 302 3400

More information